

XF

QUICK START GUIDE

CONTENTS

Driver controls	2
Vehicle access	3
Comfort adjustments	4
Starting and driving	5
Heating and ventilation	10
Audio and Touch screen	11
Navigation	14
Telephone	15
Gas station information	16

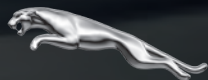

JAGUAR

Some features may not apply to your vehicle.
Refer to the Owner's Handbook for full operating instructions

DRIVER CONTROLS

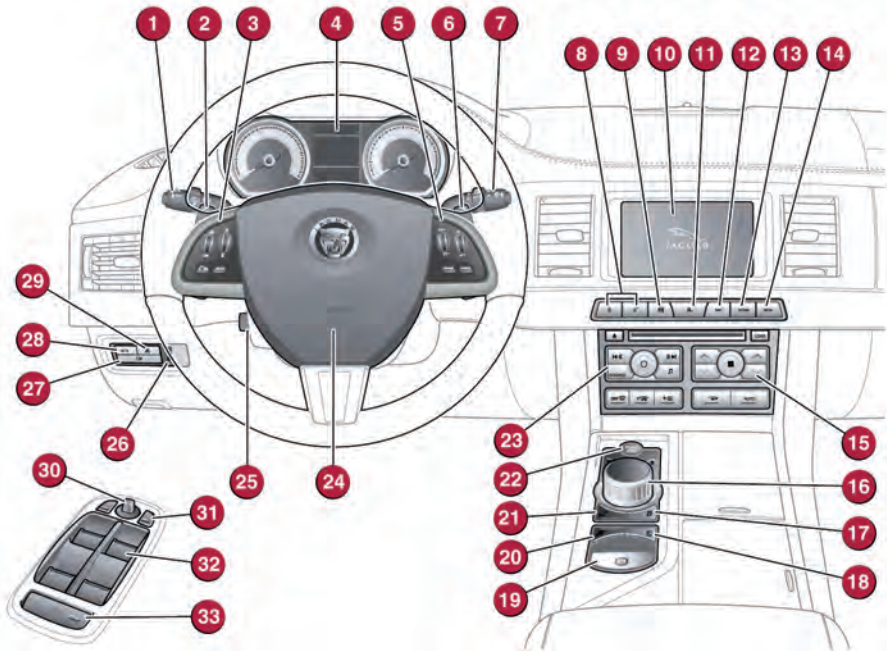

1. Headlamps, turn signals and Trip computer.
2. Manual gear change paddle (-) down.
3. Audio and phone switches.
4. Instrument panel, warning lamps and Message center.
5. Cruise control switches. Adaptive cruise control gap setting and Cruise control cancel.
6. Manual gear change paddle (+) up.
7. Wiper/washers.
8. Central locking switches.
9. Touch screen on/off or Intelligent stop/start.
10. Touch screen.
11. Hazard warning.
12. Navigation.
13. Phone menu.
14. Home menu.
15. Climate control.
16. Gear selector.
17. Dynamic stability control switch.
18. Automatic speed limiter switch.
19. Electric parking brake.
20. Dynamic mode switch.
21. Winter mode switch.
22. START/STOP.
23. Audio system.
24. Heated steering wheel/horn/air bag.

25. Steering wheel adjustment.
26. Instruments dimmer control.
27. Rear fog lamps.
28. Trunk release.
29. Forward alert.
30. Power folding mirror adjuster.
31. Power folding mirror selectors.
32. Window controls.
33. Rear window isolator.

Trunk release

With the vehicle unlocked, press **28** or the release button under the chrome finisher at the rear of the vehicle.

Rear seat release

The rear seat release handles are located inside the Luggage compartment. Pull one or both handles to release the seat backs and fold forward. Head restraints can be removed if required.

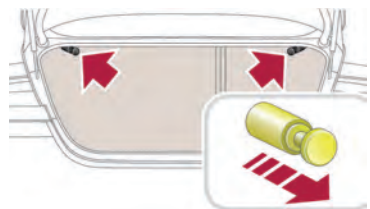

VEHICLE ACCESS

Smart key



Press once to lock the vehicle and arm only the exterior (perimetric) alarm.



Multi-point entry - Press once to disarm the alarm, unlock all of the doors and unlock the trunk.

Press and hold to unlock all doors and open the windows and sunroof (Global opening).



Press once to switch the headlamps on for up to 120 seconds. Time delay is set on the lighting control. Press again to switch off.



Press to open only the trunk. The rest of the security system remains active.



Press and hold for 3 seconds to activate/cancel the panic alarm.

Unlocking mode alternatives

Single-point entry allows only the driver's door to unlock with a single press. A second press unlocks all other doors and the trunk.

Multi-point entry will unlock all of the doors and the trunk with a single press.

To change between modes, with the vehicle unlocked, press the lock and unlock buttons simultaneously for 3 seconds. The hazard warning lamps will flash twice to confirm the change.

Emergency key release

Slide the side section up to remove. Remove the keyblade and unfold it.

Use the blade to lever off the appropriate door lock cover. The cover has a key symbol embossed into it.

Insert the key into the exposed lock, then turn and release it to unlock.

If the security system was previously armed with the Smart key, when the door is unlocked the alarm will sound. To disarm the alarm, press the unlock button on the Smart key or press the

START/STOP

button with the Smart key inside the vehicle.

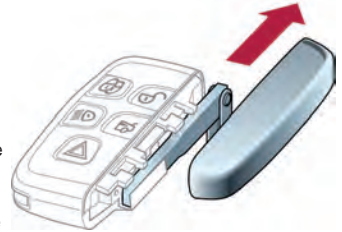

Operating note

If the Smart key fails to operate, hold it against the fascia, over the auxiliary switch pack. Start the engine as normal (see page 5). The Smart key can now be removed.

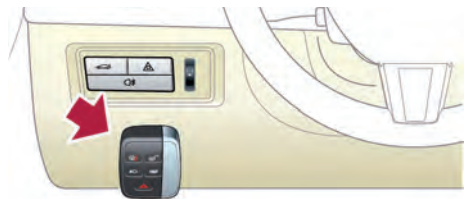

Keyless entry/exit

To unlock the vehicle and disarm the alarm, first make sure that the Smart key is outside of the vehicle but within 3 ft (1 m).

Operate a door handle or the trunk release button.

To lock the vehicle and arm the alarm, first make sure that the Smart key is outside the vehicle but within 3 ft (1 m).

Press a door handle button once to Single lock.

The Smart key may not be detected if it is placed in a metal container, or if it is shielded by a device with a back-lit LCD screen, (e.g., laptop, smart phone, etc). Keep the Smart key clear of such devices when attempting Keyless entry or Keyless starting.

Do not leave your Smart key in the trunk, as the vehicle WILL NOT automatically unlock (should it become shielded).

COMFORT ADJUSTMENTS

Setting the driving position

See page 2, items 25, 30 and 31.

Driver's seat

Set the seat position using the following controls:

1. Seatback angle and head restraint.
2. Lumbar support.
3. Side bolster - deflate.
4. Side bolster - inflate.
5. Cushion length.
6. Seat forwards and back, cushion height and cushion angle.
7. With the vehicle stationary, adjust the steering wheel to the required driving position.

Note: Seat heater controls are accessed via the Touch screen.

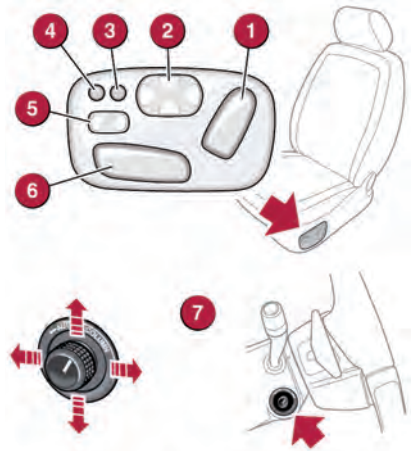

Storing the driving position to memory

When the driver's seat, steering wheel and door mirrors are adjusted to the required position, the settings can be stored.

8. Press the **SET** button to activate the memory store function. The button will illuminate to indicate the memory store function is active.
9. Press button 1, or 2 within 5 seconds to store the current driving position to the chosen number.



Use a stored memory position by pressing the appropriate button; 1, or 2. The seat, steering wheel and mirrors will move to their preset positions.

Door mirrors

1. Press the left or right mirror selector.
2. Use the mirror adjuster to set the mirror's position.

Time limit

Memory buttons must be pressed within 5 seconds after pressing the **SET** button, otherwise the memory store function will cancel.

Restraints



A warning lamp in the Instrument panel will illuminate if the seat belt of an occupied front seat is not fastened. This may be accompanied by an audible warning.

Using child seats

Refer to **Child Seat Positioning** in the Owner's Handbook to determine the correct seat for your child.

If it becomes necessary to fit a child restraint on the front passenger seat, make the following seat adjustments:

- Move the seat fully rearward.
- Adjust the lumbar support to its minimum setting.
- Adjust the seat cushion to its highest position.
- Adjust the cushion front tilt to its lowest position.
- Adjust the seatback to the fully upright position.
- Adjust the upper seat belt anchorage to its lowest position.

STARTING AND DRIVING

Engine start/stop

See page 2, item 22.

Ignition only on

- With the Smart key inside the vehicle, press the **START/STOP** button once to switch on the ignition.
- A second press will switch off the ignition.

Engine start

- The transmission must be in either **P** or **N** position to enable engine starting.
- With the brake pedal pressed, press and release the **START/STOP** button to start the engine.
- Press again to stop the engine and switch off the ignition.

Rolling start

If the engine is switched off while the vehicle is moving, it can be restarted after 2 seconds have elapsed. Select transmission **N** position and then press the **START/STOP** button.

Smart key use

The engine will continue to run, even if the Smart key is removed from the vehicle. However, if the engine is stopped, it cannot be restarted until the Smart key is returned to the vehicle.

Intelligent stop/start

See page 2, item 9.

The Intelligent stop/start system is automatically activated when the ignition is turned on. If the vehicle is stopped, the engine will turn off (unless it is required to support other vehicle systems). When the brake pedal is released and a drive gear is selected, the engine will restart automatically.



A lamp in the Instrument panel will illuminate when the engine has been switched off by the stop/start system.

To switch Intelligent stop/start off, press the ECO switch.

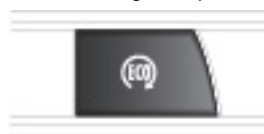

Note: The engine will restart automatically if the switch is pressed while an automatic engine stop is in progress.

Warning and information lamps

Displayed in the Instrument panel. **DO NOT** ignore warning lamps.



Braking system fault or brake fluid low. USA only.



Braking system fault or brake fluid low. Canada.



Anti-lock braking system fault. USA only.



Anti-lock braking system fault.



Engine malfunction.



Low tire pressure.



Seat belt reminder.



Automatic speed limiter active.



Dynamic stability control. Flashes when DSC is operating.



DSC switched off, TracDSC on.



Air bag fault.



Rear fog lamp on.



Forward alert active.



Adaptive cruise control active.

STARTING AND DRIVING

Transmission

See page 2, item 2, 6 and 16.



Apply the brake pedal, then rotate the gear selector from the **P** position. Maintain brake pressure until a gear is selected.

Select **P** before switching off the engine. However, if the engine is switched off with **R**, **D** or **S** selected, the selector will automatically return to **P** while retracting.

Operating note

If the engine is switched off with **N** selected, automatic selection of **P** is delayed for 10 minutes. **DO NOT** use this feature to enable towing of the vehicle. Refer to **Vehicle recovery** in the Owner's Handbook.

Automatic gear selection

Select **D** for fully automatic gear changes.

Sport mode

When selected, automatic gear change points are modified to make full use of engine power.

Press the selector down and rotate from **D** to **S**.

Manual gear changes

Manual gear change mode is effective when rapid acceleration and engine braking are required.

- To shift down, briefly pull the left (downshift) paddle.
- To shift up, briefly pull the right (upshift) paddle.

When the paddles are used while in transmission **D** position, gear selection will revert to automatic if use of the paddles is not maintained. With **S** selected, continuous manual operation is initiated if the paddles are used.

To return to automatic operation, pull and hold the right (upshift) paddle for 2 seconds or rotate the gear selector from **S** to **D** position.

Auto headlamps and wipers

See page 2, items 1 and 7.

Auto headlamps

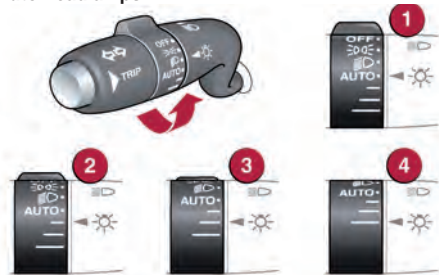

1. When the lighting control **AUTO** position is selected, the side lamps and headlamps will turn on automatically as ambient light falls below a pre-set level. With the lighting control in the low beam position, High beam assist will activate automatically in the absence of other vehicle lights ahead. The vehicle's speed must be above 25 mph (40 km/h).

2. 3. 4. The headlamps can temporarily illuminate the way ahead when exiting the car at night. Rotate the control for delay periods of 30, 60, or 120 seconds.

Auto wipers

For automatic wipe, activated by the Rain sensor, move the wiper control up to the first position. Sensitivity can be adjusted by rotating the collar.

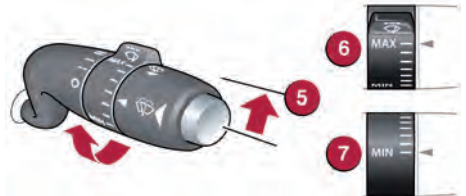

5. First stop for the Auto position.
6. Rain sensor maximum sensitivity.
7. Rain sensor minimum sensitivity.

Care point

Before entering an automatic car wash, turn the wipers off to deactivate the Rain sensor. Otherwise, the wipers will operate during the washing process and may be damaged.

STARTING AND DRIVING

Electric parking brake (EPB)

See page 2, item 19.

Applying

- With the vehicle stationary, lift up the EPB switch and then release it. The red warning lamp in the Instrument panel will illuminate.

Automatic EPB operation

The EPB will apply automatically if the ignition is switched off and the vehicle's speed is below 2 mph (3 km/h), unless transmission **P** is selected.

Releasing

- With the ignition on, apply the brake pedal and press down on the EPB switch.
- If the vehicle is stationary with the EPB applied and either **D** or **R** selected, pressing the accelerator will automatically release the EPB.

Note: Do NOT use the EPB recess as a storage area.

Cruise control and Forward alert

Setting Cruise control speed



1. Use to set the cruise speed or to increase/decrease speed while Cruise control is operating.
2. Resumes the set speed after a cancellation.
3. Press to cancel but retain the set speed in memory.

Cruise control will also cancel if the brake pedal is pressed or if the vehicle's speed falls below 18 mph (30 km/h).

Adaptive cruise control (ACC)

This enhancement uses a front mounted radar to monitor traffic ahead. ACC can be programed to maintain a set gap to the vehicle ahead. If the vehicle ahead is traveling slower than the set speed, your vehicle will automatically slow down and then maintain the set gap until the road ahead clears. At that point, your vehicle will accelerate to the set speed.

ACC gap setting

4. Press to decrease or increase the set gap to the vehicle ahead.

When ACC is active, an amber warning lamp will illuminate in the Instrument panel. The Message center will display the current set gap. There are 4 gap settings to choose from.

Set speeds are cleared at ignition switch off.

Forward alert

Forward alert is an additional feature of ACC and provides limited detection of objects in the road ahead. When necessary, it will give an audible warning plus the Message center warning **FORWARD ALERT**. The driver must take appropriate action.

5. Press to activate the Forward alert function.

The Forward alert icon will illuminate in the Instrument panel.

Sensitivity of detection can be adjusted. With ACC disengaged, use the ACC gap setting control 4 to adjust the setting.

ACC IS NOT a collision warning or avoidance system. Additionally the system WILL NOT detect:

- Stationary or slow moving vehicles below 6 mph (10 km/h).
- Pedestrians or objects in the roadway.
- Oncoming vehicles in the same lane.

STARTING AND DRIVING

Automatic speed limiter (ASL)

See page 2, items 18.

ASL allows any speed above 20 mph (32 km/h) to be set as a maximum speed. This is useful in making sure that any given speed limit is not exceeded.

Setting a speed

The setting procedure can be made while the vehicle is stationary.

1. Press the ASL button. An ASL warning lamp illuminates in the speedometer.
2. Use the Cruise control increase and decrease controls to set a speed. The Message center will display the set speed. Adjustment can be made at any time, to suit variable speed limits.



If ASL is suspended due to kick-down acceleration or by pressing the Cruise control CANCEL button, the Message center will display a **LIMITER CANCELLED** message.

Press the RESUME control to reinstate the ASL set speed. ASL will resume if the vehicle's speed is below the previously set speed limit.

When negotiating a steep downhill gradient, vehicle speed may exceed the set speed. The Message center will display a warning. Driver intervention may be required to reduce the vehicle's speed.

JaguarDrive control

See page 2, items 17, 20 and 21.

Winter mode, Dynamic mode and Dynamic Stability Control (DSC) allow the driver to more finely tune the vehicle's driving characteristics to suit prevailing conditions.



1. **Winter mode.** Use in slippery road conditions. Selects 2nd gear for driving away, moderates engine response and modifies gear change strategy, to make sure that the maximum possible traction is achieved.
2. **Dynamic mode.** Optimises the vehicle's systems to deliver a high performance driving experience. If transmission **S** is now used with paddle gear selection, there is no automatic gear change, even if the rev limit is reached. Dynamic mode remains selected for 6 hours after the engine is switched off.
3. **DSC.** The default condition at engine start is DSC on. DSC is designed to control the vehicle's stability.

TracDSC is an alternative setting that adjusts the DSC settings for maximum traction in difficult conditions. TracDSC enables a more involving and focused driving experience. To select TracDSC, press and release the button. Touch again to return to DSC. To turn DSC off, press for more than 10 seconds.

Message center

The Message center displays the transmission positions, **P**, **R**, **N**, **D** or **S**, the manual mode gear selections **1** to **8**, and the JaguarDrive Control mode selection.



When **TracDSC** is selected, the DSC warning lamp will illuminate and the Message center will briefly display **TRAC DSC**.

When **DSC OFF** is selected, the DSC warning lamp will illuminate, and the Message center will display **DSC OFF** until DSC is reinstated.

STARTING AND DRIVING

Door mirrors and Blind spot monitoring (BSM)

See page 2, items 30 and 31.

Door mirror dip when reversing

This feature can be used to improve lower side views while reversing. It can be enabled or disabled via the Touch screen. From the **Home menu**, select **Setup** then **Security/Vehicle**. Now select **Windows/Mirrors** followed by **Reverse mirror dip - On or Off**.

To set a mirror dip position:

- With the Parking brake on, select transmission **R**.
- Adjust the mirror position to view the lower rear curb and vehicle.

Subsequently, each time transmission **R** is selected, the set dip position will be automatically selected. The mirrors will return to their normal position when a forward gear is selected.



Blind spot monitoring

BSM uses radar to monitor blind spot areas. The monitored area extends approximately 20 ft (6 m) behind the rear wheels and 8.2 ft (2.5 m) to the sides. If an overtaking vehicle is identified on either side, an amber icon will illuminate in the relevant mirror to alert the driver.

An amber dot will remain illuminated until the vehicle's speed exceeds 10 mph (16 km/h).

Folding mirrors

Press both buttons simultaneously to fold the mirrors inward. Press again to unfold.

Rear camera and Parking aids

Rear camera



Activates when transmission **R** is selected. The Touch screen will display guidance lines to aid reversing. When a forward gear is selected and the vehicle's speed is greater than 11mph (18 km/h), the Rear camera will deactivate.

The Rear camera view has priority over the Parking aid view. To display the Parking aid view instead, touch the screen.

Note: Sensors may activate when water, snow, or ice are detected on the surface of the sensors. Make sure that the sensors are cleaned regularly.

Parking aids

When transmission **R** is selected, Parking aids at the rear and front will activate.



To activate the front sensors manually, press the Parking aid switch in the overhead panel.

The front sensors are deactivated when the vehicle's speed exceeds 10 mph (16 km/h).

Audible alert volume can be adjusted via the Touch screen. Select the **Home menu**, then **Setup** followed by **System**. Now select **Volume presets**. Use the + or - soft keys alongside **Parking aid** to adjust the volume.

Canceling the Parking aid screen

Touch the screen to return to the previous view.

HEATING AND VENTILATION

Heating and ventilation

See page 2, items 12 and 15.

Primary controls

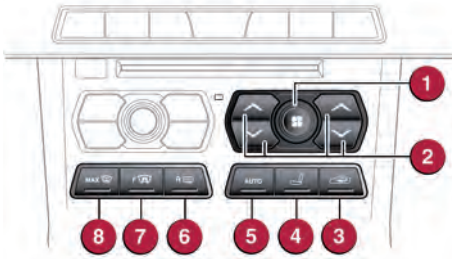

1. Press to turn Climate control on/off. Rotate to adjust airflow speed through the vents.
2. Temperature control. Temperature is displayed on the Touch screen.
3. Recirculation. Helps to prevent fumes from entering.
4. Heated/climate seats. Press to access menu options.
5. **AUTO**. This is the recommended operating mode. Automatically adjusts the air conditioning, blower speed, air intake, and airflow distribution, to maintain the selected temperature(s). Helps to prevent screen fogging.
6. Heated rear screen.
7. Heated windshield.
8. **MAX**. Fastest method to remove frost or heavy fogging from the front screen.

Touch screen controls

Touch **Climate** on the **Home** menu.

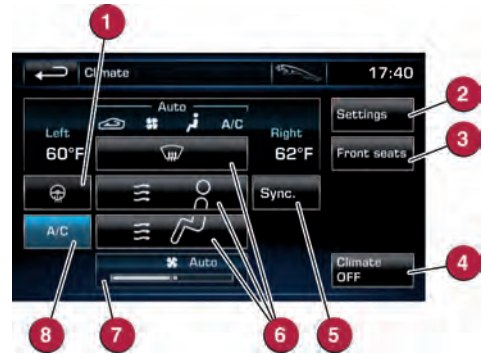

1. Heated steering wheel on/off.
2. **Settings**. Use to personalise settings.
3. **Front seats**. Temperature and ventilation.
4. **Climate Off**. Select to turn on/off.
5. **Sync.** Synchronises all front and rear settings to match the driver's.
6. Air distribution to the windshield, face and feet.
7. Indication of the selected blower speed. Use the rotary control to adjust.
8. **A/C**. Select for economy mode. Turns off the air conditioning compressor.

External water deposits

The system removes moisture from the air and deposits the excess water beneath the vehicle. This is normal and is no cause for concern.

Operating note

Seat heating and ventilating will operate only while the engine is running. This is to prevent the battery becoming discharged.

AUDIO AND TOUCH SCREEN

Home menu

See page 2, items 10, 14 and 23.

The Touch screen requires only light touches. Excess pressure could result in damage.

Operating note

Always run the engine during prolonged use of the Touch screen. This is to prevent the battery becoming discharged.



1. Eject CD.
2. Press repeatedly for available audio sources.
3. Press to switch the Audio system on/off. Rotate to adjust the volume.
4. Press to display the **Audio/Video** menu. Select any of the audio or video sources, set personal preferences, and store stations to presets.
5. Seek down and up buttons for the previous/next radio station preset, the next DVD chapter, or the next CD/MP3 track. Hold to enter manual seek mode.
6. Press repeatedly for Touch screen on/off and screen saver options (or Intelligent stop/start on/off).
7. Touch any screen soft key to make a selection.
8. Displays the **Home** menu.

Steering wheel audio/video control

See page 2, item 3.

1. Audio volume.
2. Scroll through preset radio stations, CD tracks, or music folders. Hold to select the next/previous radio station or the next CD.
3. Audio mute/unmute or activate Voice control.
4. Scroll through the audio/video source options.

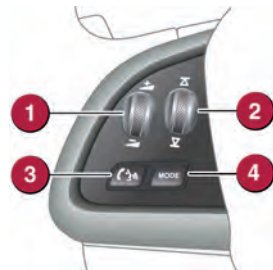

Radio

Turn on the Audio system. On the Touch screen **Home menu**, touch the **Audio/Video** option. The last used audio source controls will be displayed. If another audio source is displayed, select **Radio**.

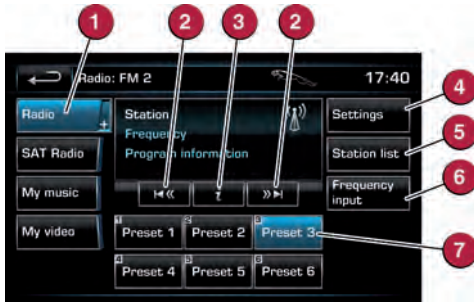

1. Touch to view and select wavebands. The + key will change to -. Touch a waveband to select. Touch - to exit the waveband selection.

2. Move up or down to the next or previous station.

3. View information broadcast by the radio station.
4. **Settings** menu. Select from **RDS**, **Traffic**, **News**, **AF**, and **REG**. The **Advanced** soft key allows favorite stations to be set for traffic and news information.
5. **Station list**. Options are available only for **FM** wavebands. All available FM stations will be listed. The list can be sorted by **Frequency**, **Name**, or **Category** (pop, news, sport), by selecting the appropriate soft key. **Autostore** replaces **Station list** when an **AM** waveband is selected. Select to store the 6 strongest **AM** stations. These stations will be on the preset keys.
6. **Frequency input**. Enter a station frequency. When the final digit is entered, the station will be tuned.
7. **Preset** soft keys. Can store 6 stations for each waveband. Touch and hold a soft key to store the current radio station.

Satellite radio

Satellite radio subscription service

Use channel 184 to preview satellite radio. When the preview time expires, you will need to subscribe to SIRIUS to enable further satellite reception.

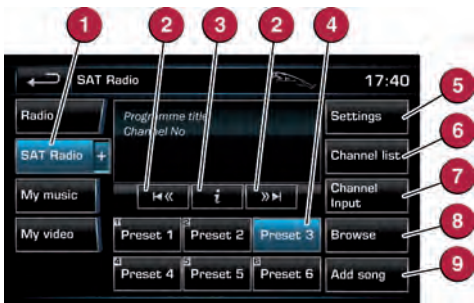

1. Touch to select the satellite bands. Touch the + icon to move through **SAT 1**, **2**, and **3**.

2. Use the seek arrows to move up or down to the next or previous channel.

3. Channel information. Select if there is more information than can fit in the display area.

4. Channel presets. Each **SAT** band has 6 preset soft keys. Touch and hold a soft key to store the current channel. A brief touch will access the stored channel.

5. **Settings**. Select to make personal settings in **Options**, **Channel skip**, and **Parental lock** areas.
6. **Channel list**. View a list of available categories.
7. **Channel input**. Select to access the touch pad. Enter any 3 digit channel number and then select **OK**.
8. **Browse**. Touch to view a list of channel categories. Select one to display full details of that channel and the current track.
9. **Add song**. Store the currently playing track to the song memory. If the Audio system subsequently finds a stored track playing on a subscribed channel, notification will be given.

Note: Use the seek buttons on the steering wheel to find preset channels.

Activating satellite radio

1. Call SIRIUS on the displayed telephone number.
2. Provide them with the ID number, also displayed on the screen.

You will also need your credit card. Make sure you are parked with a clear view of the sky while activation takes place. Activation can take up to 15 minutes.

CD player and portable media

Select the **My music** menu.



1. Select to display all of the options. Select a source.

2. **Settings** menu. Select to switch traffic and news announcements on or off.

3. Use **Track list** or **Browse** to find a track. Select the track to play.

4. Use **Upload** to load discs. The CD/DVD player will accommodate one CD or DVD disc at a time, but with Stored CD, up to 10 CD's can be loaded onto the virtual CD store. While a disc is loading, a % count up is displayed on the soft key. If the hard drive is full, select **Replace** to overwrite an existing CD.

5. Touch and release to skip up or down to the next or previous track. Touch and hold to scan forwards or back through the current track.

6. **Repeat**. Touch and release to repeat the current track continuously. Touch and release again to repeat the current stored CD (or folder for MP3 discs). Touch and release a third time to cancel Repeat mode.

Note: Repeat will cancel a previously selected Shuffle mode. Repeat mode is not available for **Bluetooth**® wireless technology devices.

7. **Pause/Play**. Select to pause playback, select again to resume playback.

8. View information about the current track.

9. **Shuffle**. Touch and release once to play random tracks from the current CD, MP3 folder, USB folder or iPod playlist. Touch and release again to play random tracks from CD, MP3 disc, USB folders or tracks on the media device, or tracks loaded onto the stored CD store. Touch and release a third time to cancel Shuffle mode.

Note: Shuffle will cancel a previously selected Repeat mode. Shuffle mode is not available for **Bluetooth** wireless technology devices.

Do not use discs with paper labels or dual format discs (Dual Discs or DVD Plus). They could become jammed inside the player.

Connecting portable media

Connecting ports for auxiliary devices, iPod, and USB storage devices, are located inside the center console cubby box.

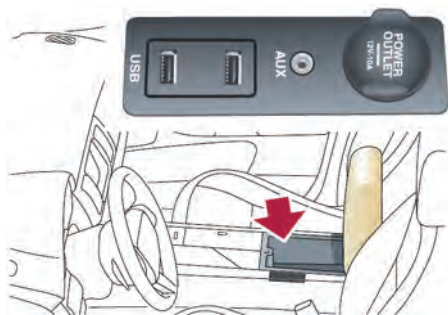

iPod and USB devices can be operated from the Touch screen. Devices connected to the 3.5mm AUX socket are controlled only from the device itself.

When connecting to the USB socket, use the cable supplied with your media device. iPod and USB devices can be operated from the Touch screen.

The system will play MP3, WMA, WAV, and AAC files from a memory stick or a USB controlled MP3 player, or a cell phone.

Some MP3 players use proprietary file systems that are not supported by the vehicle's system. MP3 players must be set to Removable Device or Mass Storage Device mode (see the manufacturer's information). Only music files added to the device while in this mode can be played via the vehicle's system.

Nav menus

Country selection

On initial activation, make sure that both the correct country and search area have been selected.

For more information, refer to the Navigation section of the Owner's Handbook.

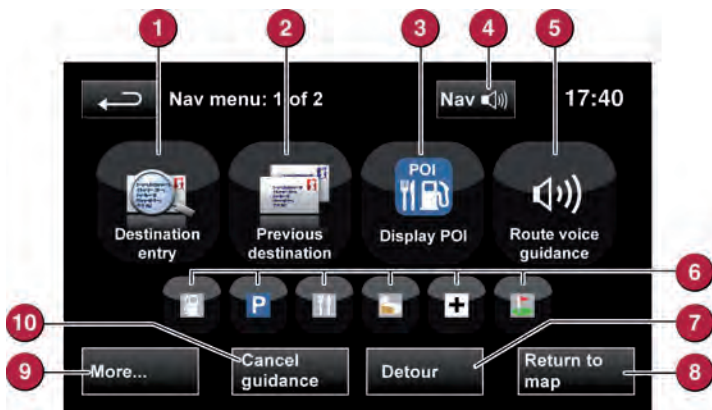

Note: To access navigation, press either the **NAV** hard key or touch the **Nav** icon on the **Home menu**.

1. Use to enter a new destination. Provides a choice of options when entering a destination.
2. Displays previous destinations entered. A previous destination can be selected as a new destination.
3. Turns the POI (Point of Interest) icons on the map on/off.
4. When a destination is set, the Jaguar logo, in this position, is replaced by a soft key which enables the last voice instruction to be repeated.
5. The soft key is highlighted while Voice guidance is enabled. Touch to turn Voice guidance off.
6. POI shortcuts: Touch an icon to list available POIs that are close to the vehicle's position.
7. Use to calculate a detour from the current route.
8. Advances to the main map screen.
9. There are 2 navigation menu screens. Use the **More...** soft key to toggle between them. The second map screen features the following soft keys:
 - **Stored locations.** Use to manage the stored data.
 - **TMC** (Traffic Message Channel). Provides data about road conditions and any events on the route ahead that may affect the current route.
 - **Route options.** Allows selection of various options for the route.
 - **Nav set-up.** For setting personal preferences within the Navigation system.
10. Cancels the current Route guidance.

Selecting navigation

When navigation is selected after the ignition is turned on, a caution screen is displayed. Touch **Agree**.

Note: At the first time of accessing the caution screen, set the required language.

Setting a destination

Select **Destination entry**.

1. Select **Address** and enter address details using the keypad.
2. As each part of the address is refined, touch **OK** or **List** to display all of the streets and towns that are available for selection.
3. If the house number is not known, touch **OK**. The end of the road is then used as the destination.
4. When the address entry fields are complete, press **OK** to move to the map screen.

Start guidance

The map screen will display the selected destination. Touch **GO** to start route calculation. Touch **Review route** if you want to take an alternative route.

Touch **Go** to start guidance.

Review route

There will be a choice of **3 routes** or **Change route**. **3 routes** will display 3 different route options on the map. Select Route 1, 2, or 3 by touching the respective box displayed on the right side of the map and then select **GO**.

TELEPHONE

Bluetooth® wireless technology devices

See page 2, item 3.

Bluetooth Connectivity

Compatible **Bluetooth** wireless technology devices can communicate with the vehicle's in-built telephone system. For the latest compatibility information, refer to www.jaguar.com and route to the Ownership area.

Connection must be made with the ignition on or the engine running.

Use the following procedure in conjunction with your phone manufacturer's instructions.

Pairing and connecting using a phone

Note: The process of pairing and connecting a phone to the vehicle will vary depending on the type of phone used.

1. Switch the ignition on and make sure that the Touch screen is active.
2. From the **Home menu**, select **Phone**.
3. If no phone is connected, select **Search new**, otherwise select **Change phone** and then select **Search new**.

4. Select the **Device to vehicle** option.

Note: The vehicle's **Bluetooth** wireless technology system is discoverable for only 3 minutes.

5. Using your phone, search for **Bluetooth** wireless technology devices. On some phones, this is referred to as a new paired device. See your phone's operating instructions for further information.
6. When the vehicle's system is discovered, begin the pairing process and follow the on-screen instructions.
7. When requested, enter a PIN of your choice into your phone and the vehicle's system. Select **OK**.
8. When your phone is paired and connected, a confirmation message will be displayed.

Note: Some phones require the pairing to be set as 'authorised' or 'trusted', in order to automatically connect. Please refer to your phone's operating instructions for further information.

Downloading phonebook entries

When a phone with phonebook download capability is paired and docked, its phonebook directory can be automatically downloaded to the vehicle's system.

See **PHONEBOOK** in the Owner's Handbook for more information.

Calls via the Touch screen



With a paired and active phone, press the **PHONE** button below the Touch screen.

1. Select **Digit Dial**, **Phonebook**, or **Last 10**. With **Digit Dial** selected, use the keypad to enter the number. With **Phonebook** selected, choose a number from the downloaded phonebook. **Last 10** displays the previous 10 calls. Choose one to dial.
2. Touch the green connect icon to make a call. The icon will change to a red connected call icon. Touch the red icon to end a call.

Calls via the steering wheel controls

1. Volume control. Turn to increase/decrease the call volume.
2. Scroll control. Turn to scroll up/down lists of calls or phonebook entries.

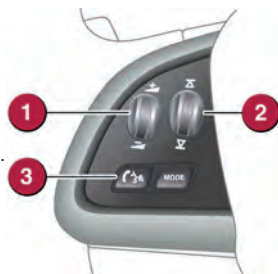

3. Phone/Voice control. Press and release to dial, accept, or end a call. If Voice control is not fitted, in addition to the above, press and release to access the **Last 10** dialled list. Press and hold to access the **Phonebook** search view.

Signal reception

- Reception is dependent on the phone and network signal. Performance may be improved by changing your phone's settings (e.g., from 3G to 2G).
- If echo is experienced during a call, reduce the Audio system volume.

GAS STATION INFORMATION

Refueling

The fuel filler flap is located on the right side of the vehicle. If the vehicle is locked, the filler flap cannot be opened.

Press the flap firmly, approximately 1.4 in (35 mm) from the rear edge and release. Pull the flap open. The correct fuel specification is shown on the inside of the fuel filler flap.

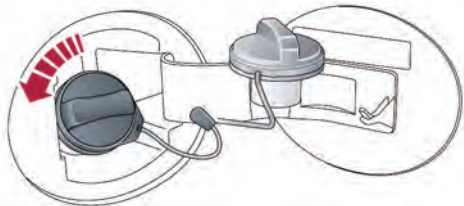

Twist the cap counter-clockwise to release. A hook is provided on the flap hinge to hold the cap while refueling.

Use premium unleaded fuel with a minimum octane rating of 91 AKI to achieve optimum performance, fuel economy, and driveability.

After refueling, tighten the cap clockwise until it clicks 3 times.

If the vehicle can use E85 fuels (85% ethanol content), it will be stated on a label on the back of the fuel filler flap. When using E85 fuel, 1 in 4 tanks of fuel must be non-E85 premium quality unleaded fuel.

Note: Do not use E85 fuel in ambient temperatures lower than 14° F (-10° C).

DO NOT use E85 fuels if it is not specified on a label on the back of the fuel filler flap. Equipment necessary for the use of fuels containing more than 15% ethanol is not fitted to this vehicle. If E85 fuels are used, serious engine and fuel system damage will occur.

Avoid using fuel containing methanol. If it is unavoidable, do not use a fuel with more than 10% methanol content. The fuel must contain co-solvents and corrosion inhibitors. Fuel system damage and engine performance problems can occur when methanol is used.

Unleaded fuels containing up to 15% MTBE can be used.

No responsibility is accepted for damage caused by using incorrect fuels.

If the vehicle is filled with the wrong type of fuel:

- **DO NOT start the engine!**
- **Call for qualified assistance!**

Hood release

The hood release is located in the left side footwell.

Tire pressure label location

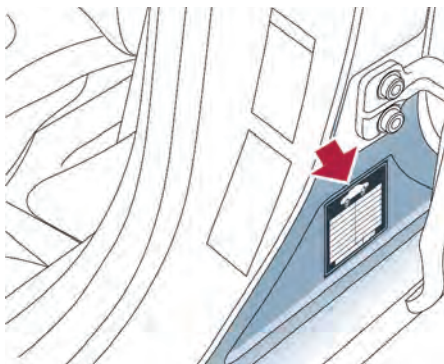

Tire pressures are shown on a label located in the driver's door opening.

Note: Tire pressures must be checked and adjusted while the tires are cold.